

Order #XXXXX - ECO-2012-B - 10'x20' Sustainable Exhibit

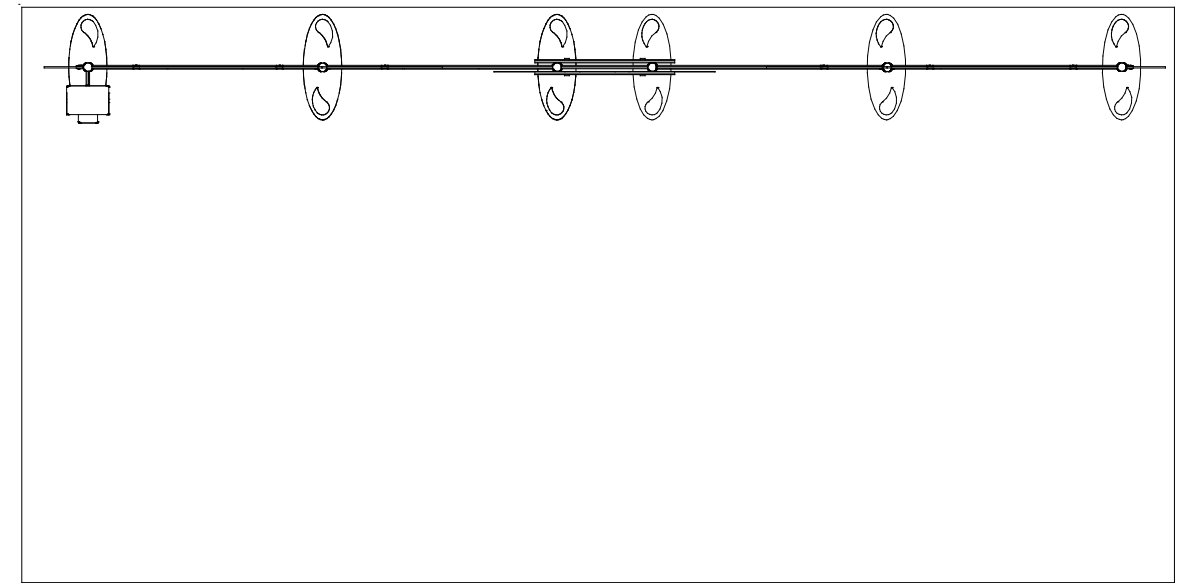

10'

20'

Plan View

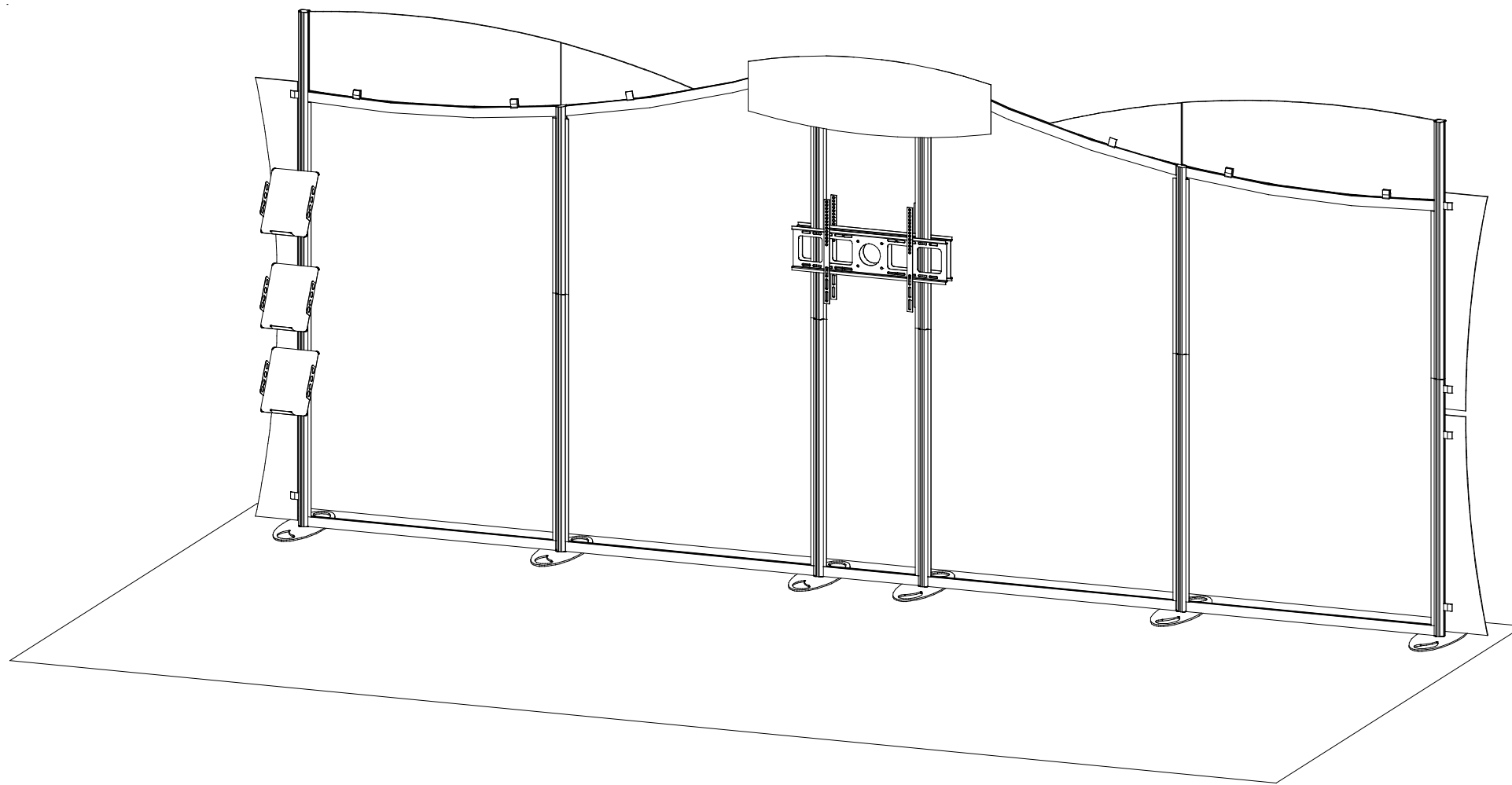

General Setup Instructions

- The setup instructions are created specifically for your configuration.
- Setup instructions are laid out sequentially in levels, including exploded views and a logical series of steps for assembly. We encourage you to study the instructions before attempting to assemble your exhibit.

Cleaning and Packing

- Use non-abrasive cleaners when cleaning extrusions or ECO Glass inserts.
- Use mild cleaners and soft materials such as cotton to clean all laminates.
- Keep exhibit components away from extreme heat and long exposure to sun light. This will prevent warping and fading.
- Retain all packing material for ease of re-packing. This protects the exhibit components and keeps each part organized.

Disassembling

- When disassembling exhibit, tighten all setscrews to prevent loss of hardware in the shipping process.

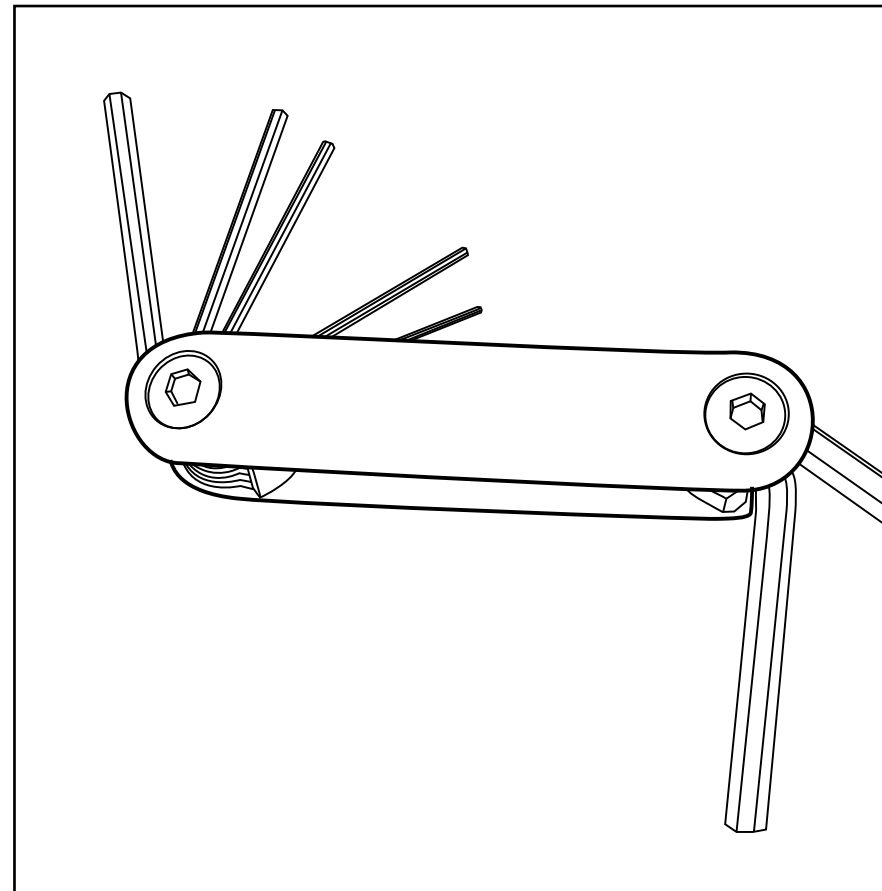

Hex Tool for Assembling Exhibit

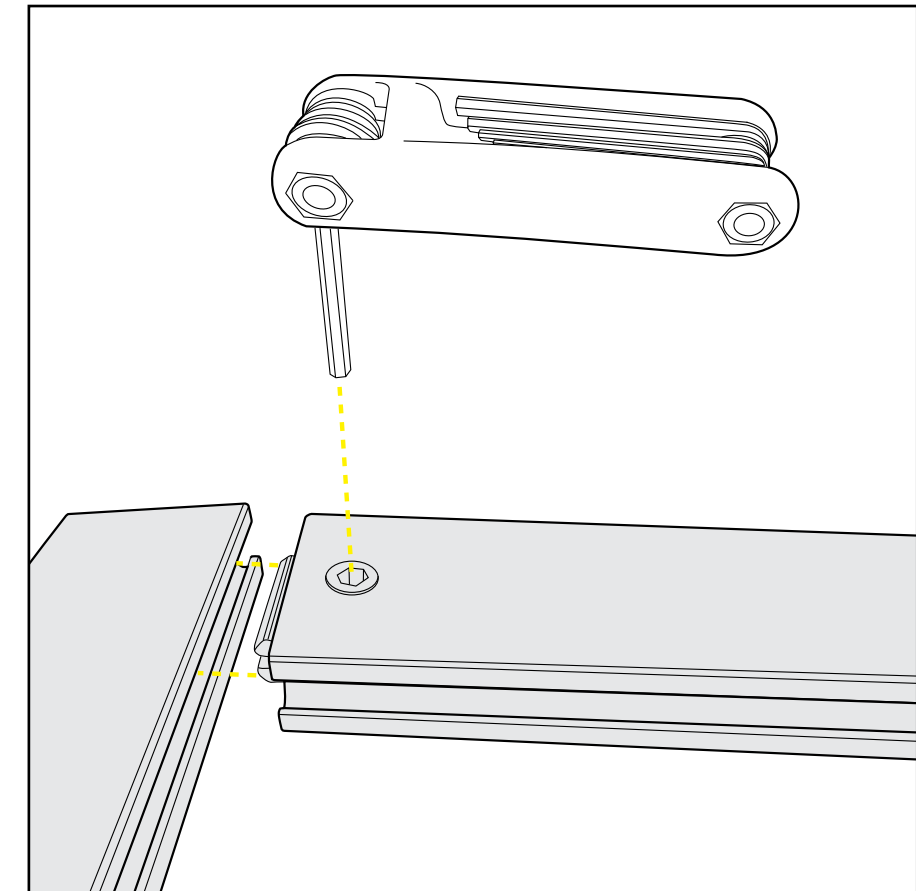

Extrusion Lock Connectors

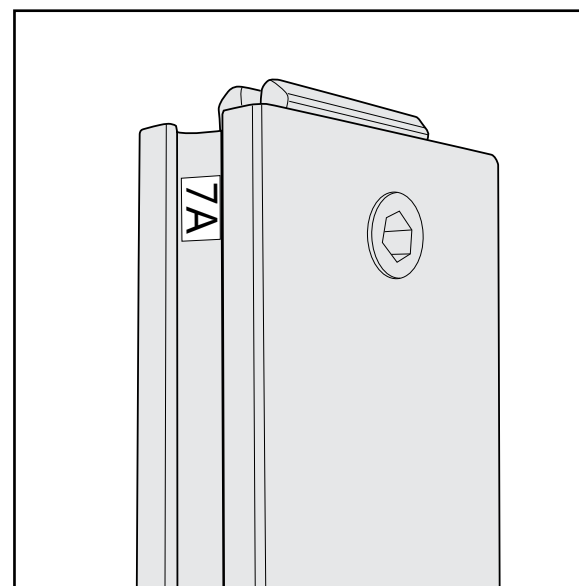

Numbering Instructions for Setups/Packing

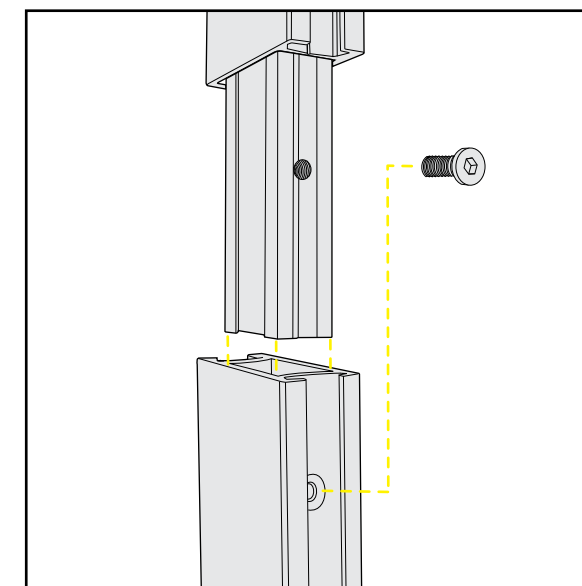

Inline Connection between Extrusions

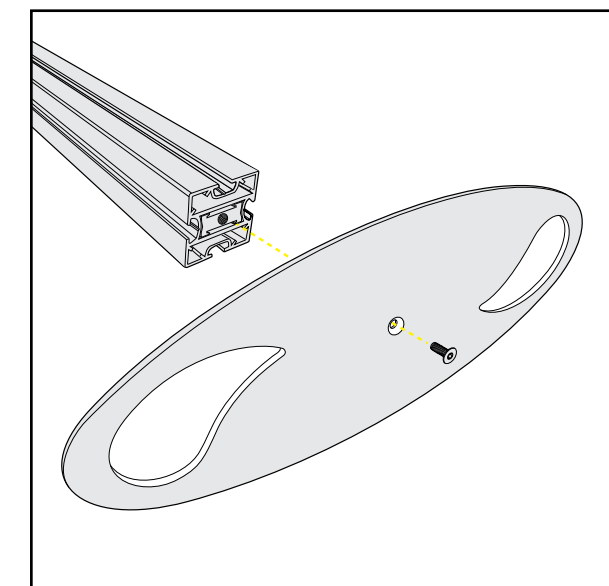

Baseplate Connection for Vertical Extrusions

ECO Panel Install

- 1 Place ECO panel together with a vertical offset, slide down to lock connector in place.
- 2 Panel Corner Connectors are installed just like ECO panels. Remove by off-setting top lock clips horizontally followed by separating vertically.

SEG Graphic Install

- 1 Graphic is installed corners first. This allows a proportional fit around the perimeter of the extrusion.
- 2 Locate channels along the edge of the extrusions.
- 3 Fold over graphic (hiding threads) and tuck silicon edge and fabric into corners.
- 4 After corners are complete, slide in the rest of the graphic into channel. (From edges to center)
- 5 Graphic is installed. Stand back and be amazed!

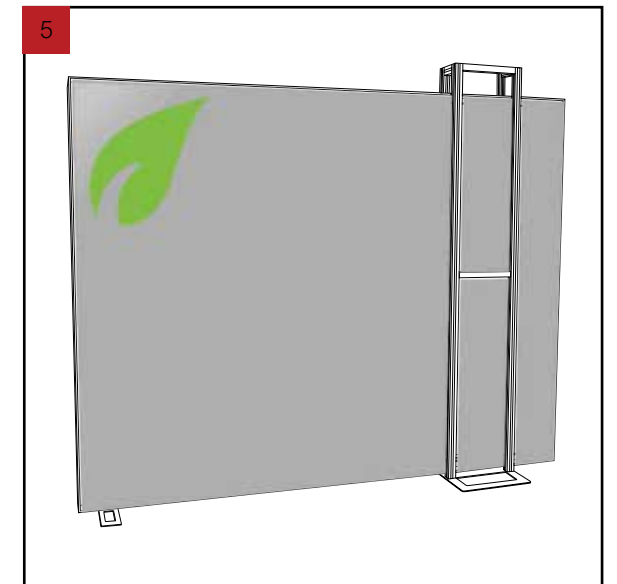
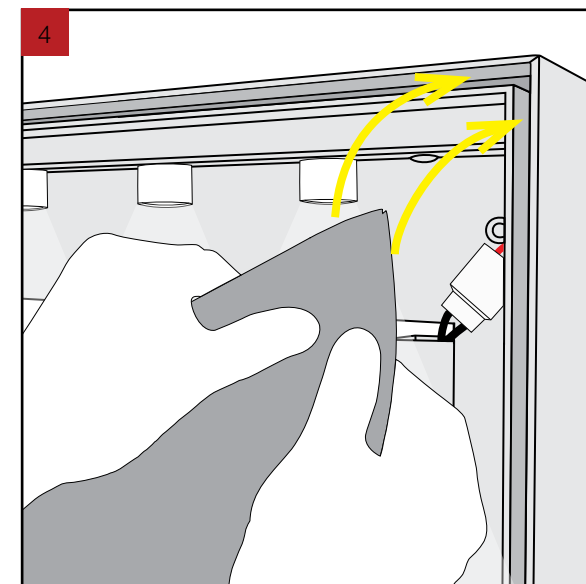
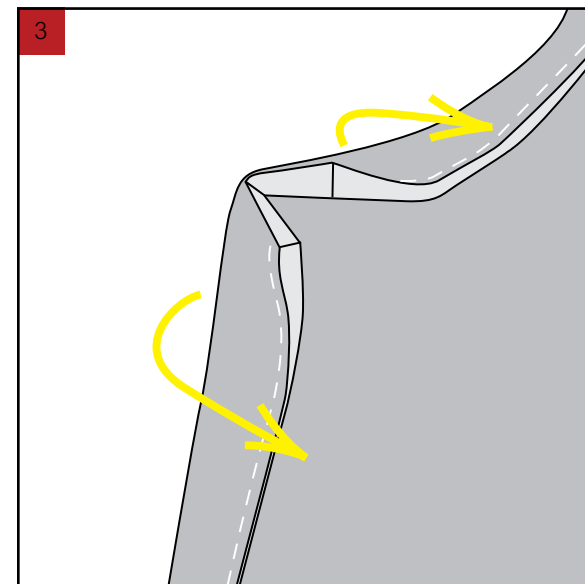
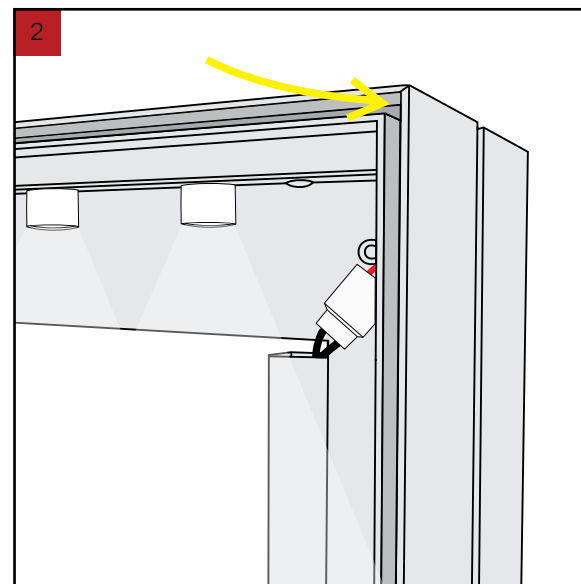
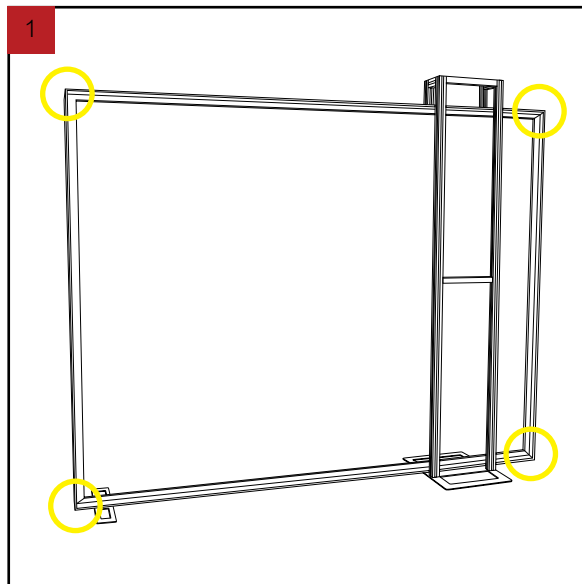
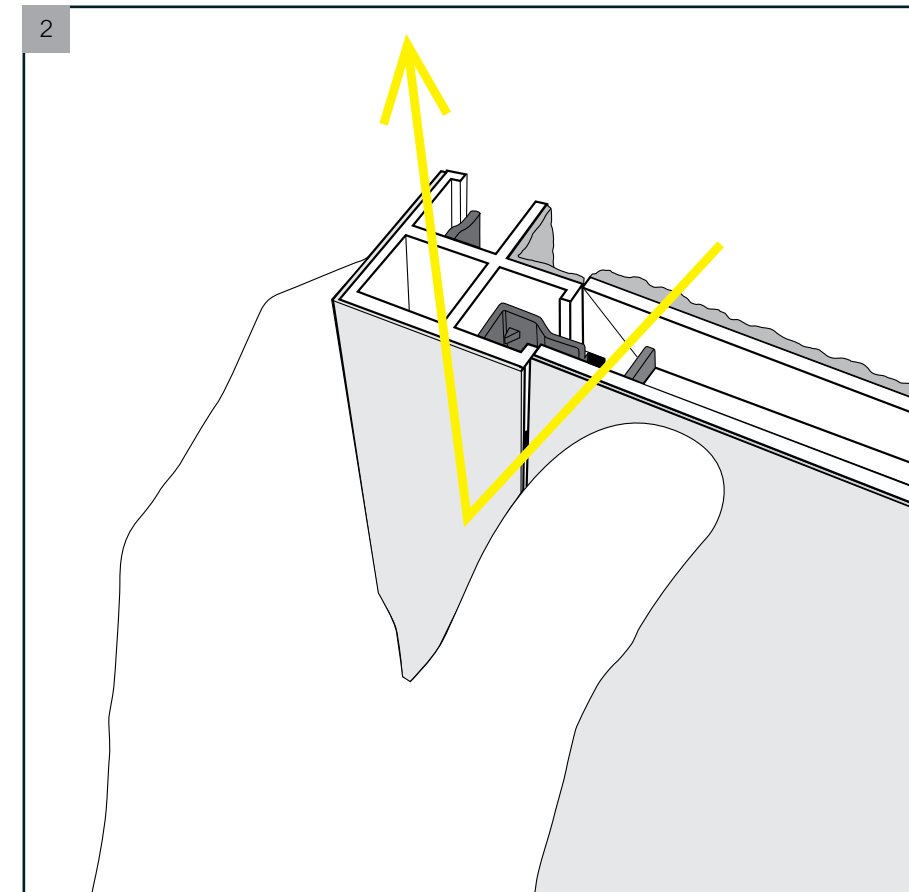
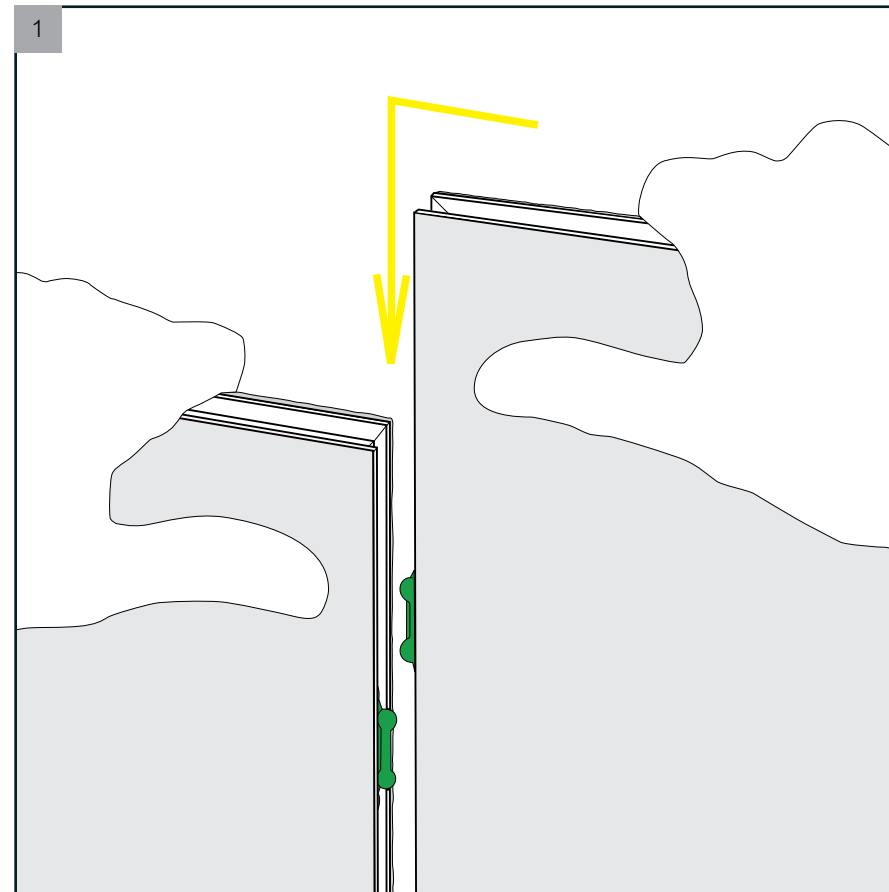

| Item | Qty. | Description |
|------|------|---|
| 1 | 6 | Base Plate |
| 2/2A | 1/1 | 47" h RSG540 Vertical Extrusion w/ attached PR37 |
| 3 | 1 | 47" h RSG540 Vertical Extrusion w/ attached PR37 |
| 3A | 1 | 34.36" h RSG540 Vertical Extrusion w/ attached PR37 |
| 4/4A | 1/1 | 47" h RSG540 Vertical Extrusion w/ attached PR37 |
| 5/5A | 1/1 | 47" h RSG540 Vertical Extrusion w/ attached PR37 |
| 6 | 1 | 47" h RSG540 Vertical Extrusion w/ attached PR37 |
| 6A | 1 | 34.36" h RSG540 Vertical Extrusion w/ attached PR37 |
| 7/7A | 1/1 | 47" h RSG540 Vertical Extrusion w/ attached PR37 |
| 8 | 4 | 47" w Z45 Horizontal Extrusion |
| 9/9A | 1/1 | 18" w Z45 Horizontal Extrusion |
| 10 | 1 | 47.121" Z45 curved Horizontal Extrusion |
| 11 | 1 | 48.739" Z45 curved Horizontal Extrusion |
| 12 | 1 | 48.739" Z45 curved Horizontal Extrusion |
| 13 | 1 | 47.121" Z45 curved Horizontal Extrusion |

Steps:

- 1) Install Base Plates [1] to lower vertical extrusions [2,3,4,5,6,7], using bolts.
- 2) Attach upper verticals [2A,3A,4A,5A,6A,7A] to lower verticals [2,3,4,5,6,7].
- 3) Connect horizontals [8,9,9A,10,11,12,13] between verticals.
- 4) Apply fabric graphics to front of assembly using [Velcro](#).

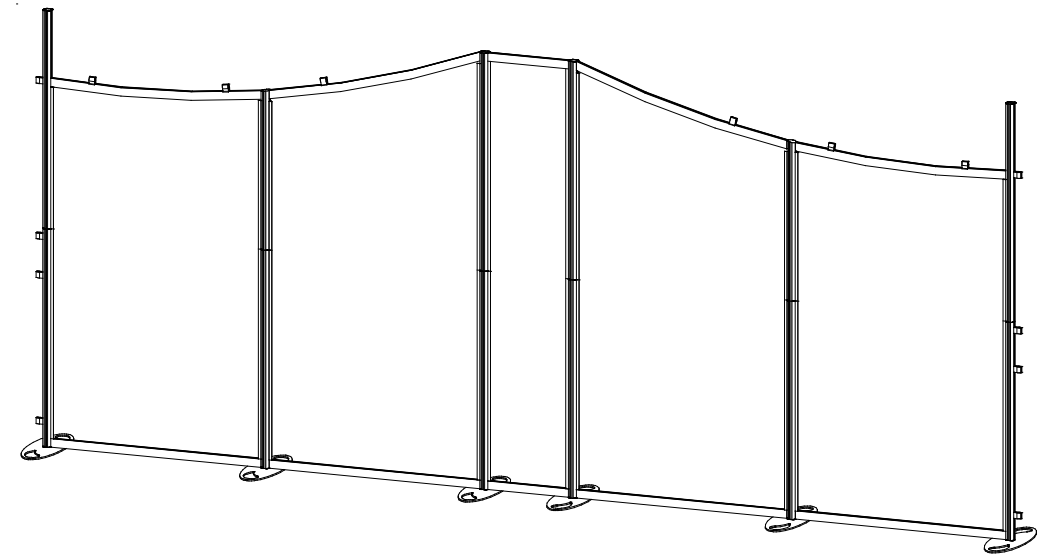

When assembled

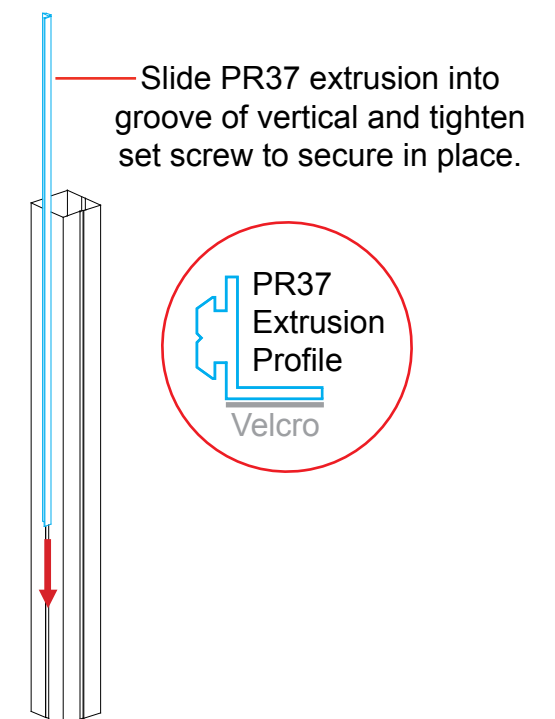
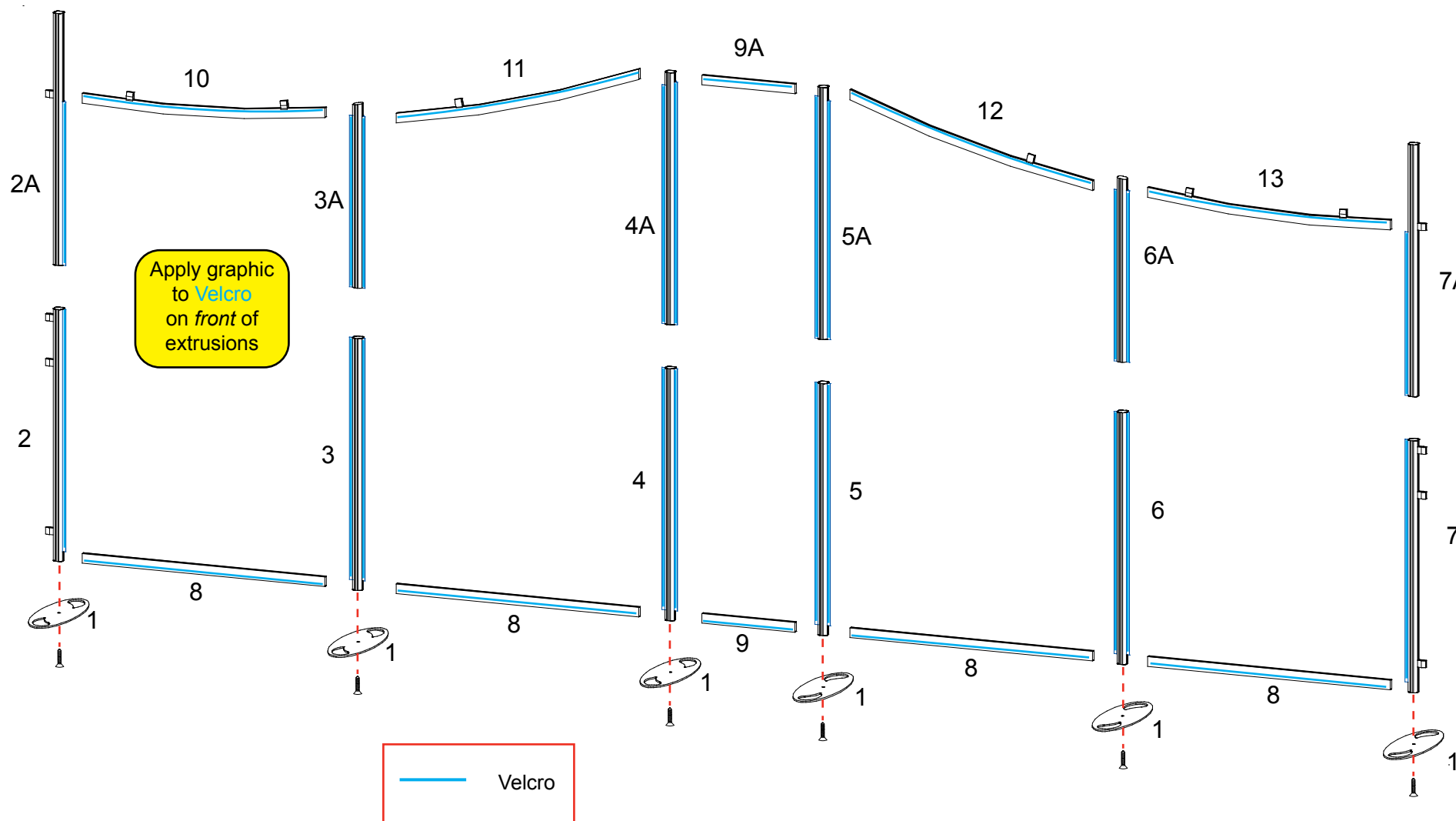

Steps:

- 1) Attach wings and header to backwall using A10 clamps.
See **A10 Clamp** detail.
- 2) Connect Monitor Mounts to backwall verticals.
See **Monitor Mount Attachment** detail.
- 3) Install Literature Trays to vertical [2/2A].
See **Literature Tray Attachment** detail.
- 3) Attach **Front Graphic** to front of verticals using **Velcro**.

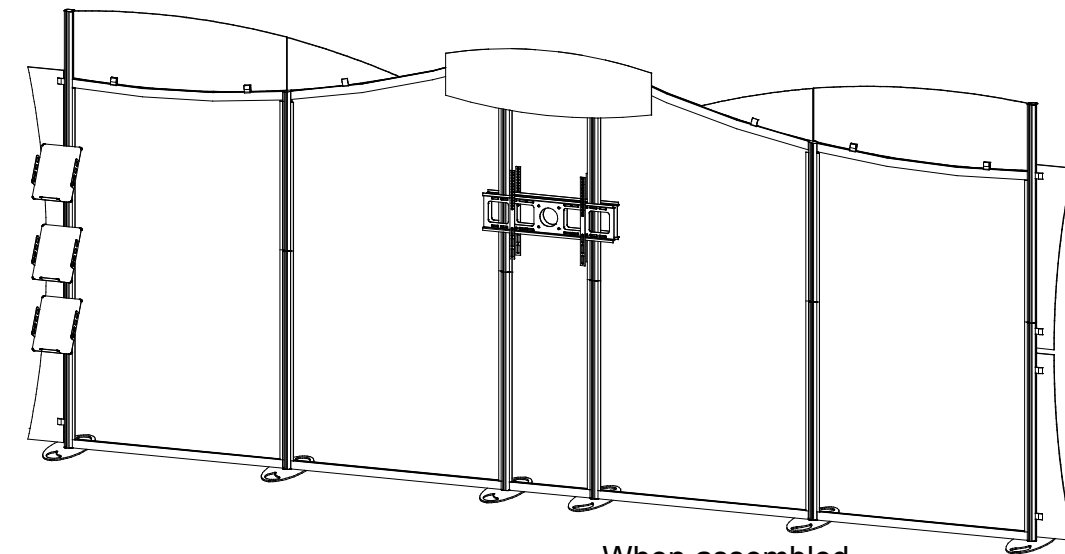

When assembled

*** Monitor Mount Attachment**

Slide mounting connector pieces into groove of extrusion. Tighten setscrew to secure in place.

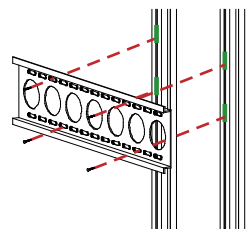

Then attach wall plate to connectors using supplied bolts.

*** Literature Tray Attachment**

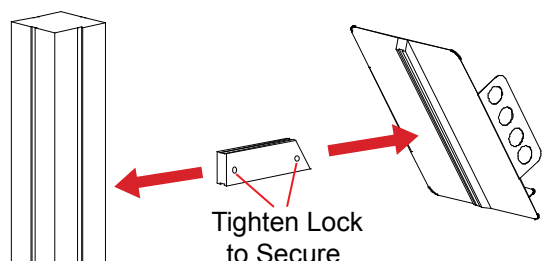

- 1) Attach connector to literature tray.
- 2) Connect assembled literature tray to vertical extrusion.

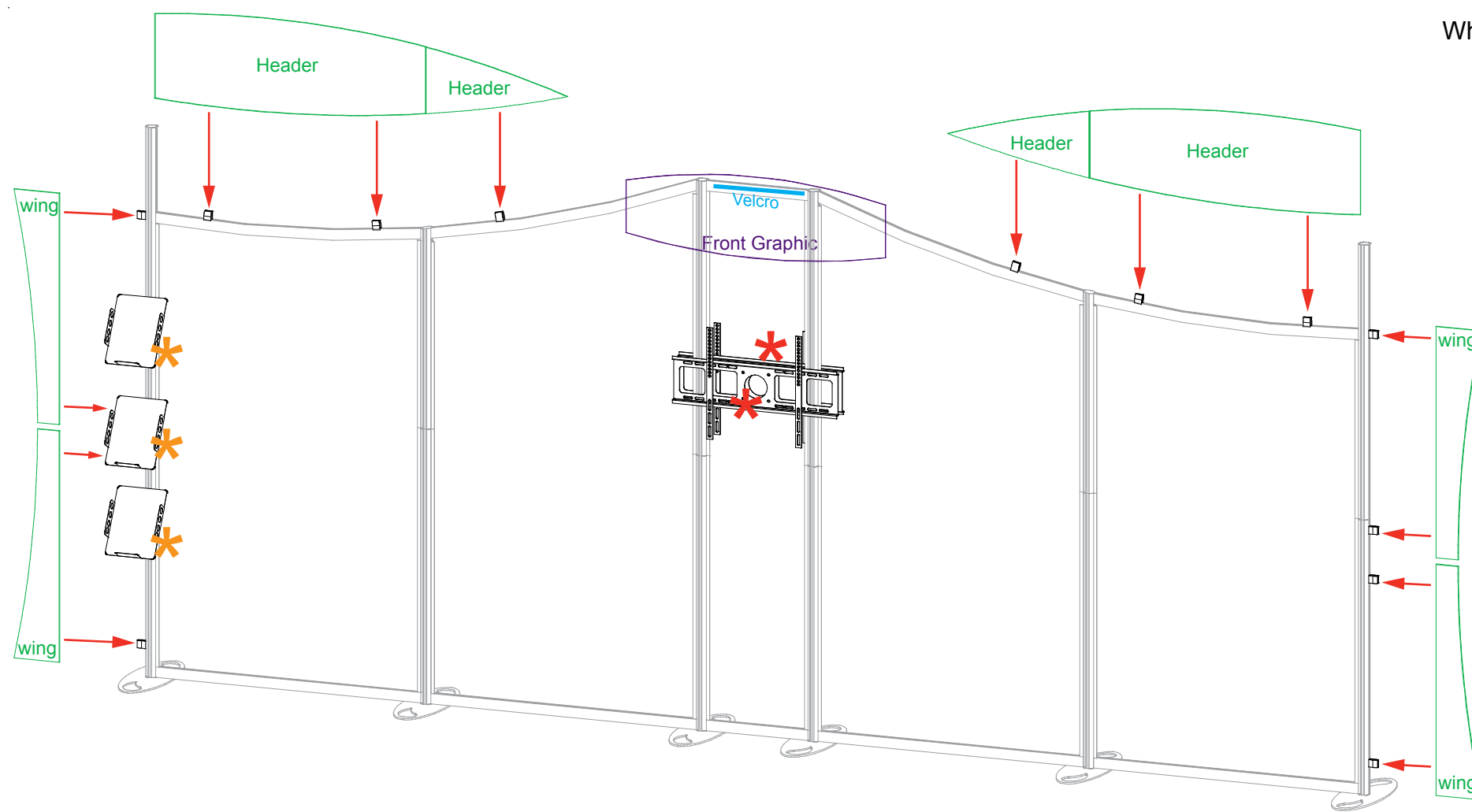

A10 Clamp

Connector

- 1) Slide Connector of Clamp into extrusion groove.
- 2) Tighten set screw when A10 is in desired location.
- 3) Insert Wing into Clamp.
- 4) Tighten knob on Clamp to secure Wing in place.

Set Screw
A10 Clamp
Knob